

Product diagram

Zenn
CUSTOMER IS KING

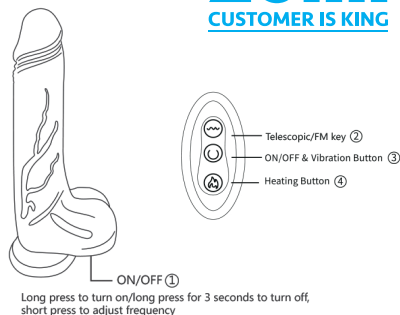

Telescopic frequency control button:

Short press to adjust the frequency of the 10-frequency function, long press for 3 seconds to turn off the function.

On key+vibration frequency modulation key:

Short press to adjust the 10-frequency vibration intensity, long press for 3 seconds to turn off all functions.

Heating button:

Short press to turn on heating, short press to turn off the function.

Remarks:

1. First, long press and turn on the penis switch, then short press and turn on the remote control main switch (the red light is on), in order to enter the working state of the remote control.
2. Press to turn the heating on and off.

operation instructions

1. Before use, rinse with water or shower gel and wipe dry immediately;
2. This product can be sucked, or used to stimulate the chest, or the product can be inserted into the genital and anal area to obtain pleasure.
3. You can turn on the vibration frequency you need.
4. After use, rinse thoroughly with water or shower gel, dry immediately, and store in a cool place.

Remote control power supply instructions

1. To maintain remote operation, A 1.5 drycellis required. If the battery fails, please replace it with a new one. The battery should be placed in the battery compartment with the correct polarity. If the product has not been used for a long time, please remove the battery in a timely manner.
2. The battery used in this remote control is a non rechargeable battery. Non rechargeable batteries cannot be charged. It is recommended not to mix different types of batteries or old and new batteries. Batteries should not be exposed to environments such as sunlight, fire, or similar overheating and humidity. Batteries should be placed with the correct polarity.
3. Before and after each use of this product, please thoroughly clean it. Before cleaning, ensure that the product is turned off, the battery is removed, and the product is in a closed (Close) state.

Power supply instructions

1. Connect the USB cable to a USB power adapter (excluding the accessory) or USB port, and you can use any USB power adapter for charging.
 2. A complete charge takes approximately 1.2-2.0 hours. The specific charging time may vary depending on the amount of residual electricity inside this device.
 3. After fully charging, the usage time of this device is approximately 40 to 60 minutes, depending on the vibration mode you choose. The higher the frequency of the vibration mode, the faster the battery consumption.
- Before abandoning the appliance, the battery must be removed from the appliance. When removing the battery, the appliance must be powered off and the battery should be disposed of safely.

Maintenance and upkeep

1. Before and after each use, please use neutral soap and water to clean and dry, and stay away from extreme high or low temperature environments.
2. Please store this product in a cool, ventilated, and dry place, ensuring that it is protected from direct sunlight, high temperature, heavy pressure, humidity, and pollution.

Warning:

1. It is recommended to use lubricating fluid for the first time when using it.
2. Make sure to turn off the power of the dildo and the remote control after use, so as not to affect the use of the battery.
3. Wash with clean water or neutral detergent after use, and dry in a ventilated place after washing.
4. The product is waterproof for life, so it is not recommended to use it directly in water.
5. The heating time is about 4-5 minutes, please use it with caution for people who are sensitive to heat.



Made in Germany
Powered by Eros

Zenn
CUSTOMER IS KING

HIGH
EUROPEAN
QUALITY

www.zenn.at



Art. nr. 260023



THE BEST GLIDE ASK YOUR SHOP

A DIRTY MIND IS A JOY FOREVER

MADE IN PRC
B&C Sales bv • De Ruijterstraat 12 • 6651 ZH • Druten • The Netherlands